

## Parameters

Electric Parameters (from HDL-MPPI.46):	
Working power	12~30VDC
DC current	45mA
Bus Terminal	Wago 252, 0.75-0.85mm Diameter Single Core
Environmental Conditions:	
Working Temperature	-5°C~45°C
Working relative Humidity	Up to 90%
Storage Temperature	-20°C~+60°C
Storage relative Humidity	Up to 93%
Approved:	
CE	
RoHS	
Production Information:	
LCD Resolution	240x80
Dimensions	86×116.5×10.5 (mm)
Weight	129g
Housing material	Glass , ABS, PC
Installation	GI Wall-Box
Protection	IP20

## Important Notes

- It must work in conjunction with HDL-MPPI.46 (be installed in wall-box)

## Installation Step

- Mount the HDL-MPPI.46 in the wall-box
- Make sure the Bus cable type is correct and has no short circuit.
- Connect bus cables. Make sure the color of wire complies with the definition
- Put this device into HDL-MPPI.46

## HDL Buspro Definition for Cable

HDL Buspro	HDL Buspro/KNX
DC24V	Red
COM	Black
DATA-	White
DATA+	Yellow

## Overview



**HDL-MPTL14.46** Multifunction LCD panel is the new design and new generation wall mount panel. It has 8 touch buttons, these buttons can be programmed separately. Each control button can be displayed with an Icon in the LCD screen and customization for the end-user. There are 2 buttons to be used for the page shifting. 4 shortcut buttons can reach to the certain page, the page can be defined by user.

## Functions

- Adjustable LCD backlight and LED indicator.
- Multipage, Specified page for floor Heating, HVAC, music control function.
- Icon for Key Buttons can be defined by user
- Button indicator's color is RGB
- Wake up function
- Shortcut button function
- Button combination and Double Button combination function available
- Button mutual exclusion available
- Upgrading online from HDL Buspro is available
- Multi Key Mode: Invalid, Single on-off, single on, single off, Combination on-off, combination on, combination off, double click/single on-off, double click/combination on-off, momentary, clock, short/long press, short press/long momentary press, hyperlink
- Multi Key control Mode: Scene, Sequence, timer switch, universal switch, single channel on-off, broadcast scene, broadcast channel, curtain, GPRS Control, Panel Control, alarm control, music play, General control.
- Functions including the following: IR Receiver is optional, lock, AC control, heating control, music control, lighting control, curtain control, security control, multimedia control

## Dimensions and Wiring

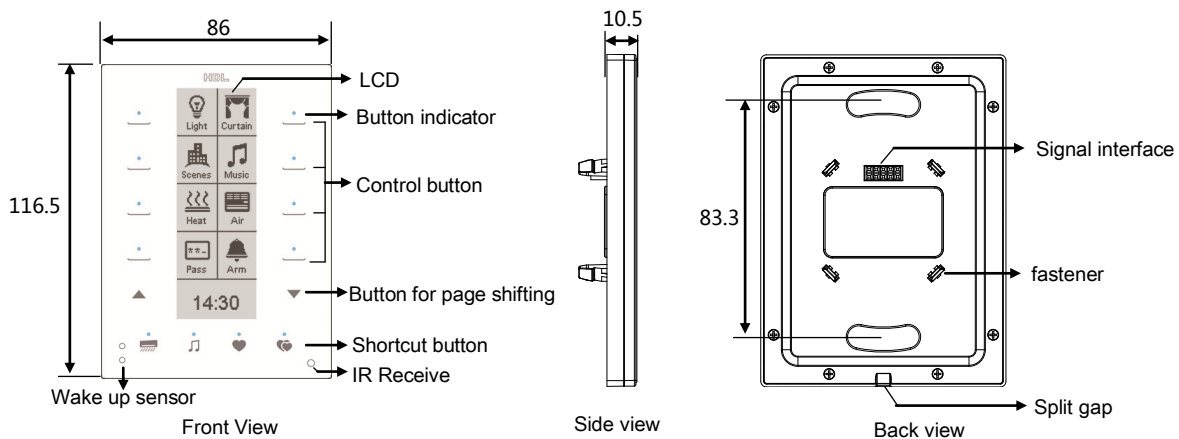

**LCD:** Display icons, user can design icons from manage software

**Control Button:** To control targets.

**Button Indicator:** Indicates the status of the controlled target. On- Status on; Off- Status off. User can define the color of status.

**Dimming:** When control types are scene and single-channel lighting on-off, keep pressing the button for dimming.

**Button for page shifting:** For user to select different pages.

**Shortcut button:** Directly reaches to a certain page

**IR receiver:** IR remote control.

**Wake up function:** The LCD will light up if a hand approaches the panel

**Signal interface and fastener:** Connect to panel power interface (MPPI.46)

**Split gap:** Insert a slotted screwdriver to the split gap, separate the panel and power module (MPPI.46).

## Installation

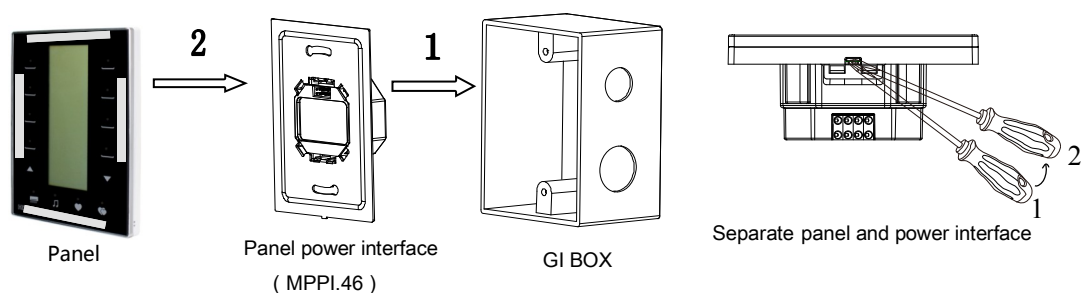

**Installation:** Held the edge of panel (shown as above grey area), insert the power interface module vertically. Do not push the panel too hard.

**Split:** Insert a 2.5mm-screwdriver to the split gap. Pry up from position 1 to 2, wiring hole will open. Then separate the panel and MPPI.48.

## Safety attention



- Mounting position: indoor
- Do not make wrong connection on Bus interface, it will damage the Bus interface of this module
- Never let liquids get into the module, it will damage this device
- Do not get AC power into Bus wire, it will damage all devices in the system

