

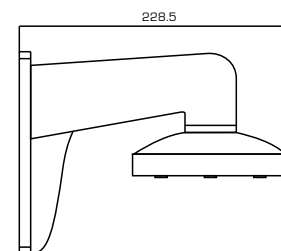

FEATURES:

- Aluminum alloy material with surface spray treatment
- The outlet hole makes the feature look better
- Better water proof design
- Convenient installation coordinating with lower bowl

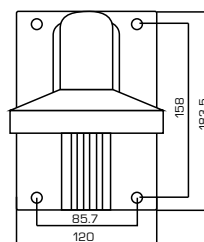
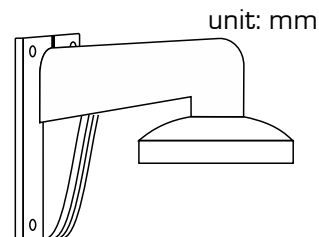
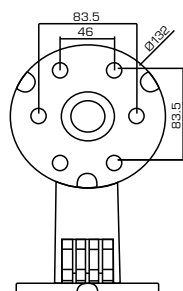

SPEC	
Parameters	Wall mount
Colour	Hik Grey
Feature	Suitable for dome camera
Material	Aluminum alloy
Dimension	132 x 183.5 x 228.5mm
Weight	870g

Installation View

1. Choose appropriate wall to fix the bracket and wire

2. Fix cap to bracket and complete wiring

3. Screw up and fix the cap

4. Take adaptor from the package of bracket

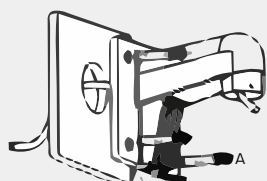

A: Cable entry hole

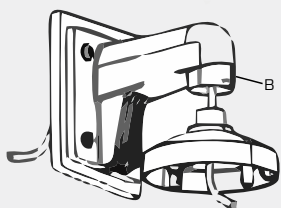

B: Fastening screw

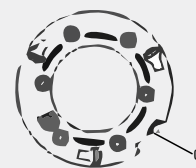
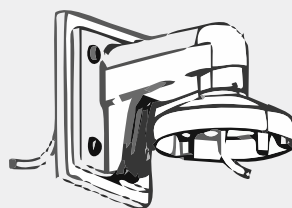

C: Bayonet of adaptor

5. Check the hole site and fix adaptor to cap

6. Connect the cable and fix dome camera to cap

7. Rotate the dome camera moderately and screw up the fastening screw

8. Installation complete

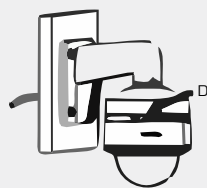
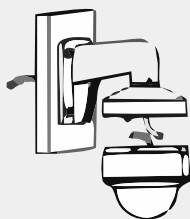

D: Fastening screw of dome camera

