

BT7808

CEILING / WALL MOUNT WITH TILT FOR Ø50MM POLES

Designed to ceiling mount Ø50mm poles, the BT7808 features an adjustable tilt mechanism with a tilt range of up to 90°. This makes it ideal for mounting flat screens and projectors to flat or angled ceilings and also allows wall mounted installations in both portrait or landscape configurations.

SPECIFICATIONS

Max load	140kg
Tilt	+90°
Colour	Black or White

FEATURES

- 1 Up to +90° tilt of pole for angled ceilings or walls
 - 2 Keyhole fixing for hassle free 'hook-on' installation
 - 3 Pole mount screens from flat or angled ceilings
 - 4 Also ideal for mounting projectors to the ceiling
- Designed to mount a Ø50mm pole to a flat or angled ceiling
 - Allows poles to be mounted on to walls in horizontal or vertical configurations

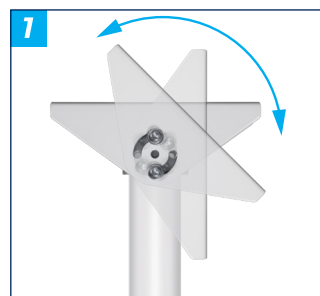
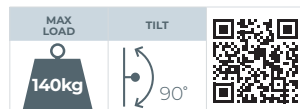

BT7808

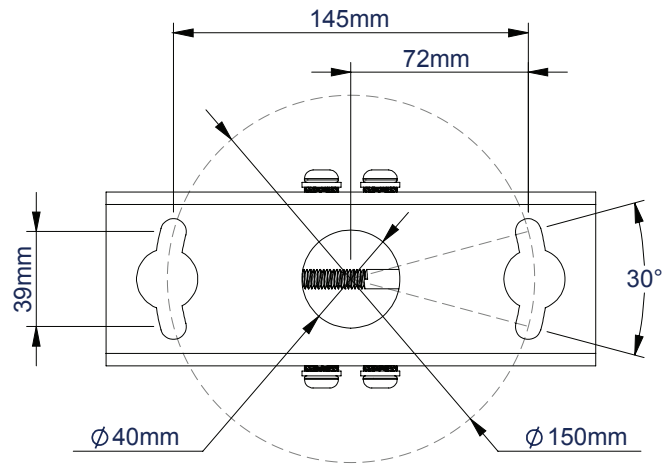

TOP VIEW

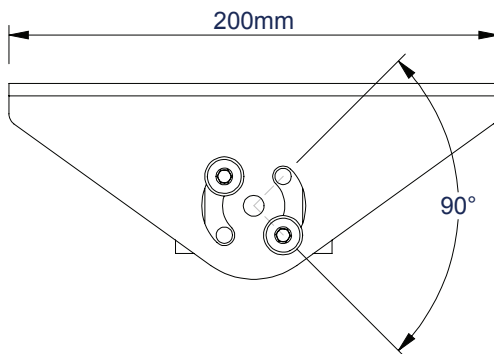

SIDE VIEW

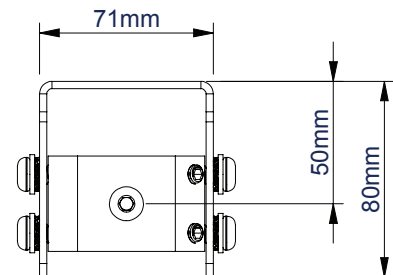

FRONT VIEW

ORDERING INFORMATION

COLOUR	ORDER REF	EAN
Black	BT7808/B	5019318759697
White	BT7808/W	5019318306273

RELATED PRODUCTS

PRODUCT CODE	NAME	DESCRIPTION
BT7850	Ø50mm Poles	Designed for ceiling, floor or floor-to-ceiling installations, available up to 3m
BT7841	50mm Accessory Collar	For fixing mounts & accessories to Ø50mm poles
BT8431	Flat Screen Wall Mount with Tilt	Fits to Ø50mm poles using 2x BT7841 collars
BT899	Heavy Duty Projector Mount	Fits directly to Ø50mm poles