

Pico 4-Button Wireless Control (for regions other than North, Central, and South America)

The Pico wireless control is a flexible and easy to use device that allows the user to control Lutron wireless load-control devices from anywhere in the space. This battery-operated control requires no external power or communication wiring.

Features

- Provides control for the following:
 - Vive¹ systems, including:
 - PowPak relay module, CCO module, and 0–10 V_{rms} (EcoSystem module not available)
 - Energi Savr Node systems programmed with handheld App, through the use of a QS sensor module (QSM)²
 - PowPak modules (EcoSystem module not available)
 - GRAFIK Eye QS wireless systems
 - HomeWorks QS wireless systems
 - RA2 Select wireless systems
 - Serena RF remote control shades
 - Sivoia QS wireless systems
 - Quantum systems³, through the use of a QS sensor module (QSM)²
 - myRoom prime and plus systems
- NOTE: Not all systems are available in all regions.
- Custom engraving options.
 - Control available in a variety of button marking options.
 - Control available in textured finishes only.
 - Easy reconfiguration for use as:
 - Handheld remote
 - Wall-mount control (with or without faceplate; faceplate adapter kit sold separately)
 - Car visor control (car visor clip sold separately)
 - Table-top control (table-top pedestal sold separately)

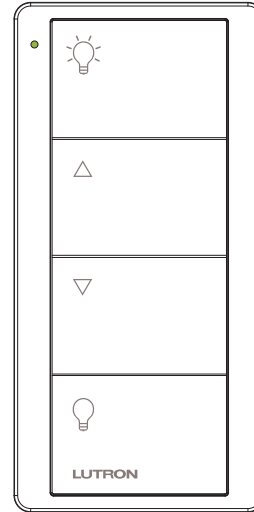

Pico 4-Button Wireless Control

* Lights zone control printing shown

- Utilizes Lutron reliable Clear Connect RF technology.
- Battery-powered. Requires no wiring.
- 10 year battery life⁴ (one CR2032 battery included).
- Can provide control of shades, drapes, or lighting devices within a range of 9 m (30 ft) through walls and 18 m (60 ft) line-of-sight.

¹ Available in version 01.06.13 or higher.

² Requires version 8.012 or higher.

³ Available in version 3.4 or higher.

⁴ Based on a 1 year shelf life, an average of 10 button presses per day, and an ambient temperature of 30 °C (86 °F). Actual life may vary based on usage and environmental conditions.

Job Name:	Model Numbers:
Job Number:	

Specifications

Regulatory Approvals

- Lutron Quality Systems registered to ISO 9001:2015.
- PK2 (Europe)
 - TRA Certified
 - CE Marked
- PN2 (India)
 - WPC Certified
- PM2 (China)
 - imDA Certified
- PQ2 (Hong Kong)
 - RCM Compliant
- RoHS Compliant

Power

- Operating Voltage 3 V \equiv
- (1) CR2032 battery (included)

System Communication and Capacity

- Pico wireless controls communicate using Radio Frequency (RF). See “Frequency/Channel Codes” in the Model Number section for more information.
- Thousands of system addresses prevent interference between systems.
- Can be assigned to control shades, drapes, or lighting devices within a range of 9 m (30 ft) through walls and 18 m (60 ft) line-of-sight.

Mounting Considerations

- All RF devices should be mounted on non-metallic surfaces to ensure proper performance.
- If you wish to mount your Pico wireless control to a metallic surface, the PICO-MOUNT-1-XX-CPN6774 will be required in order to maintain proper RF performance. For availability, please contact your local Lutron sales office.

Environment

- Ambient operating temperature:
0 °C to 60 °C (32 °F to 140 °F)
- Maximum 90% non-condensing relative humidity
- Indoor use only

Warranty

- 1 Year Limited Warranty. For additional Warranty information, please visit www.lutron.com/TechnicalDocumentLibrary/369-119_Wallbox_Warranty.pdf

Job Name:	Model Numbers:
Job Number:	

Dimensions

Measurements shown as: mm (in)

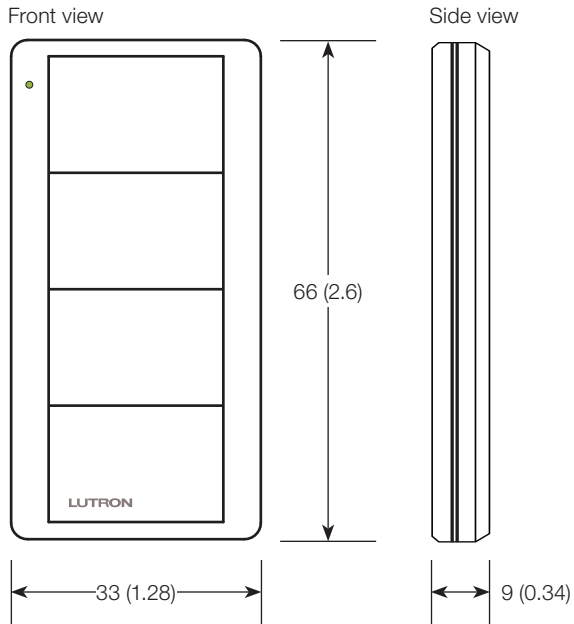

Job Name: Job Number:	Model Numbers:
------------------------------	----------------

Operation

Indicator LED
Flashes to indicate a button press or when unit is in programming mode.

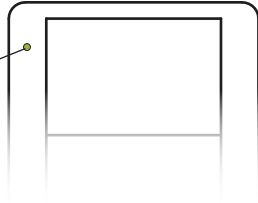

Zone Controls

Lights Models: L01, EL1

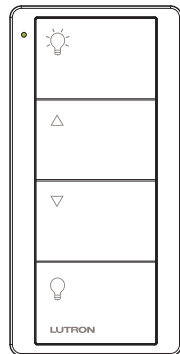

- ON Button**
Lights brighten to full intensity.
- Raise Button**
Lights increase in intensity.
- Lower Button**
Lights decrease in intensity.
- OFF Button**
Lights dim to off.

Shades Models: S01, ES1

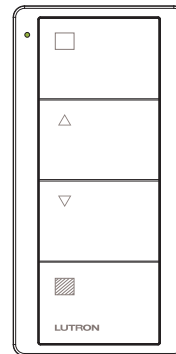

- OPEN Button**
Shades open fully.
- Raise Button**
Shades open gradually.
- Lower Button**
Shades close gradually.
- CLOSE Button**
Shades close fully.

Zone Controls (-S01, -ES1) Shade Functionality†

System Type	Serena Wireless	Triathlon Wireless	Sivoia QS Wireless	Sivoia QS Wired
Standalone Pico	Yes	Yes	Yes	Yes ¹
RA2 Select	—	Yes	Yes	—
HomeWorks QS	—	Yes ²	Yes ²	Yes ²
Quantum	—	—	—	Yes ¹
myRoom prime	Yes	Yes	Yes	Yes ¹
myRoom plus	—	Yes ²	Yes ²	Yes ²

¹ QS Sensor Module (QSM) required.

² Either a QSM or a Hybrid Repeater is required.

† Only 868 MHz functionality shown, please contact your local Lutron sales office for specific shading and system availability with other frequencies.

(continued on next page...)

Job Name:	Model Numbers:
Job Number:	

Operation (continued)

Scene Controls (Default settings: 100%, 66%, 33%, 0)

Lights Models: L31, EL2

Shades Models: S31, ES2

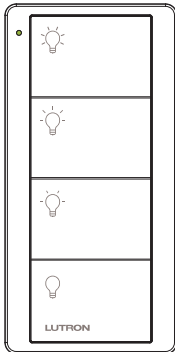

3 Scene Buttons
Tap once: Sends device to preset levels.
Press and hold for 6 seconds: Saves new preset level or position.

OFF Button
Lights dim to off.

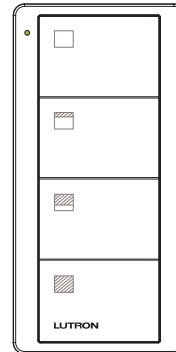

OPEN Button
Shades open fully.

2 Scene Buttons
Tap once: Sends device to preset levels.
Press and hold for 6 seconds: Saves new preset level or position.

CLOSE Button
Shades close fully.

Scene Controls (-S31, -ES2) Shade Functionality †

System Type	Serena Wireless	Triathlon Wireless	Sivoia QS Wireless	Sivoia QS Wired
Standalone Pico	—	—	Yes	—
RA2 Select	—	Yes	Yes	—
HomeWorks QS	—	Yes ¹	Yes ¹	Yes ¹
Quantum	—	—	—	Yes ²
myRoom prime	—	—	Yes	Yes ²
myRoom plus	—	Yes ¹	Yes ¹	Yes ¹

¹ Either a QS Sensor Module (QSM) or a Hybrid Repeater is required.

² QSM required.

† Only 868 MHz functionality shown, please contact your local Lutron sales office for specific shading and system availability with other frequencies.

(continued on next page...)

Job Name:	Model Numbers:
Job Number:	

Operation (continued)

2-Group Controls

Lights Model: L21

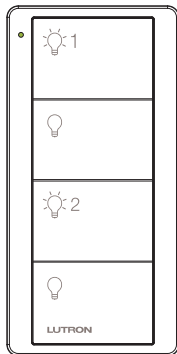

- ON Button #1**
Lights brighten to full intensity.
- OFF Button #1**
Lights dim to off.
- ON Button #2**
Lights brighten to full intensity.
- OFF Button #2**
Lights dim to off.

Shades Model: S21

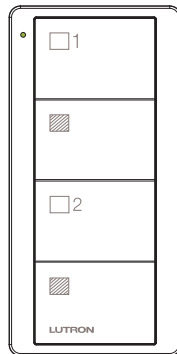

- OPEN Button #1**
Shades open fully.
- CLOSE Button #1**
Shades close fully.
- OPEN Button #2**
Shades open fully.
- CLOSE Button #2**
Shades close fully.

Lights/Shades Model: LS21

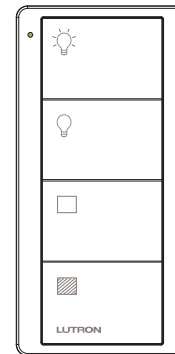

- ON Button**
Lights brighten to full intensity.
- OFF Button**
Lights dim to off.
- OPEN Button**
Shades open fully.
- CLOSE Button**
Shades close fully.

2-Group Controls (-S21, -LS21) Shade Functionality†

System Type	Serena Wireless	Triathlon Wireless	Sivoia QS Wireless	Sivoia QS Wired
Standalone Pico	—	—	Yes	—
RA2 Select	—	Yes	Yes	—
HomeWorks QS	—	Yes ¹	Yes ¹	Yes ¹
Quantum	—	—	—	Yes ²
myRoom prime	—	—	Yes	Yes ²
myRoom plus	—	Yes ¹	Yes ¹	Yes ¹

¹ Either a QS Sensor Module (QSM) or a Hybrid Repeater is required.

² QSM required.

† Only 868 MHz functionality shown, please contact your local Lutron sales office for specific shading and system availability with other frequencies.

(continued on next page...)

Job Name:	Model Numbers:
Job Number:	

Operation (continued)

4-Group Toggle (HomeWorks QS, Quantum, and myRoom plus systems only)

Model: L41

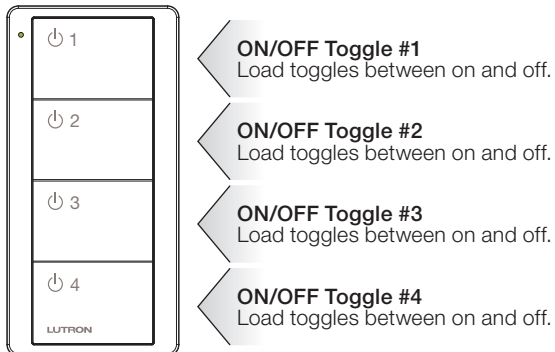

4-Group Toggle Controls (-L41) Shade Functionality†

System Type	Serena Wireless	Triathlon Wireless	Sivoia QS Wireless	Sivoia QS Wired
Standalone Pico	—	—	—	—
RA2 Select	—	—	—	—
HomeWorks QS	—	Yes ¹	Yes ¹	Yes ¹
Quantum ²	—	—	—	Yes ²
myRoom prime	—	—	—	—
myRoom plus	—	Yes ¹	Yes ¹	Yes ¹

¹ Either a QS Sensor Module (QSM) or a Hybrid Repeater is required.

² QSM required.

† Only 868 MHz functionality shown, please contact your local Lutron sales office for specific shading and system availability with other frequencies.

Job Name:	Model Numbers:
Job Number:	

Model Number

For order quantities of 96 pieces or greater of the same model number, bulk packaging may be available. Mounting hardware is not included with bulk packaging. For availability, please contact your local Lutron office.

Standard Icon Models

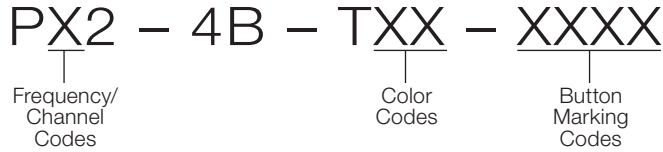

Frequency/Channel Codes

K: 868.0 – 869.8 MHz

M: 868.0 – 868.5 MHz

N: 865.5 – 866.5 MHz

Q: 433.0 – 434.7 MHz

NOTE: Contact Lutron for frequency band compatibility for your geographic region. All wireless devices need to be the same frequency band for proper operation.

Color Codes

Color	Code
White	AW
Black	BL

Button Marking Codes

Zone Controls

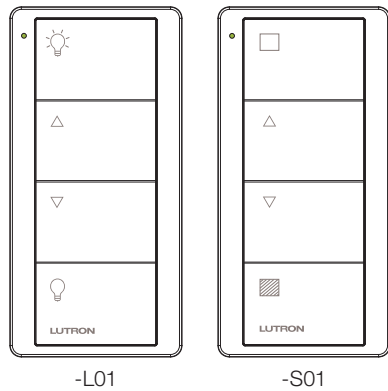

Scene Controls

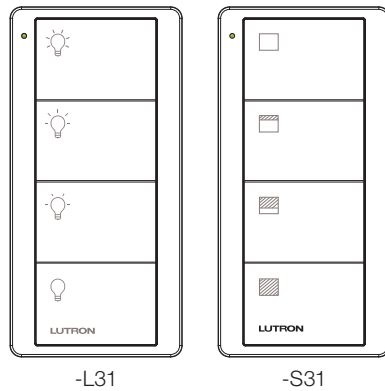

2-Group Controls

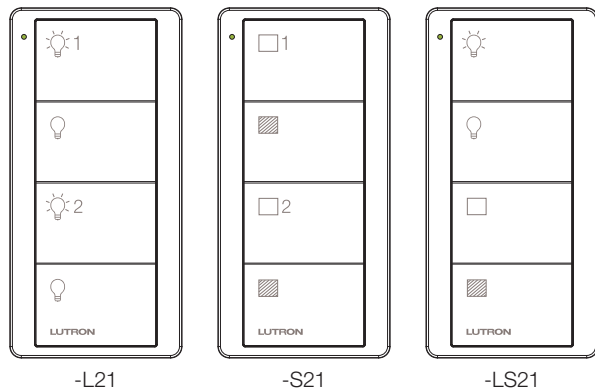

4-Group Toggle*

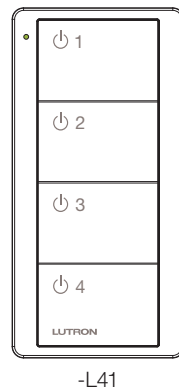

* HomeWorks QS, myRoom, and Quantum systems only

(continued on next page...)

Job Name:	Model Numbers:
Job Number:	

Model Number (continued)

Customizable Engraving Models

Pico 4-Button wireless controls offer customizable engraving on Zone and Scene controls for both lights and shades. The following text restrictions and button marking codes must be considered when ordering.

PX2 - 4B - TXX - XXXX

Frequency/
Channel
Codes

Color
Codes

Button
Marking
Codes

Frequency/Channel Codes

K: 868.0 — 869.8 MHz

M: 868.0 — 868.5 MHz

N: 865.5 — 866.5 MHz

Q: 433.0 — 434.7 MHz

NOTE: Contact Lutron for frequency band compatibility for your geographic region. All wireless devices need to be the same frequency band for proper operation.

Color Codes

Color	Code
White	AW
Black	BL

Button Marking Codes

Custom-engraved models for Zone control keypads (-L01, -S01) and Scene control keypads (-L31, -S31) are available but require a different set of button marking codes when ordering.

Note: 2-Group (-L21, -S21, -LS21) and 4-Group Toggle (-L41) controls are not offered with the custom engraving option.

	Button Marking Codes	
	Standard Engraving	Custom Engraving
Zone Control of Lights	-L01	-EL1
Zone Control of Shades	-S01	-ES1
Scene Control of Lights	-L31	-EL2
Scene Control of Shades	-S31	-ES2

When selecting alternate labels for buttons, remember button functionality presets as shown in the **Operation** section on pages 4, 5 and 6. The examples to the right show sample text choices.

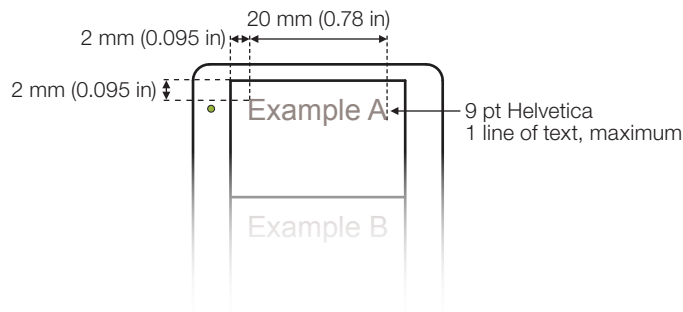

Zone Controls

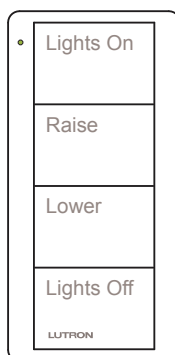

-EL1
(lights example)

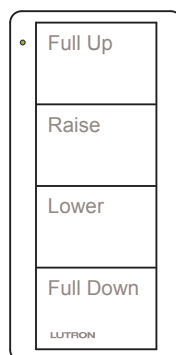

-ES1
(shades example)

Scene Controls

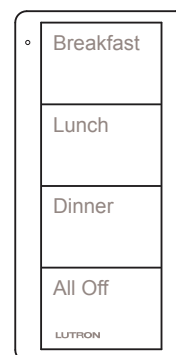

-EL2
(lights example)

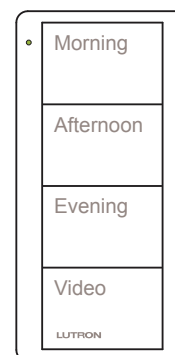

-ES2
(shades example)

Job Name:	Model Numbers:
Job Number:	

Pico Pedestal Model Number

Pedestals sold separately.

L – PEDX – XX

Capacity Codes

Capacity	Code
Single	1
Double	2

Color Codes

Color*	Code
White	WH
Black	BL

* Available in gloss finish only.

Dimensions

Measurements shown as: mm (in)

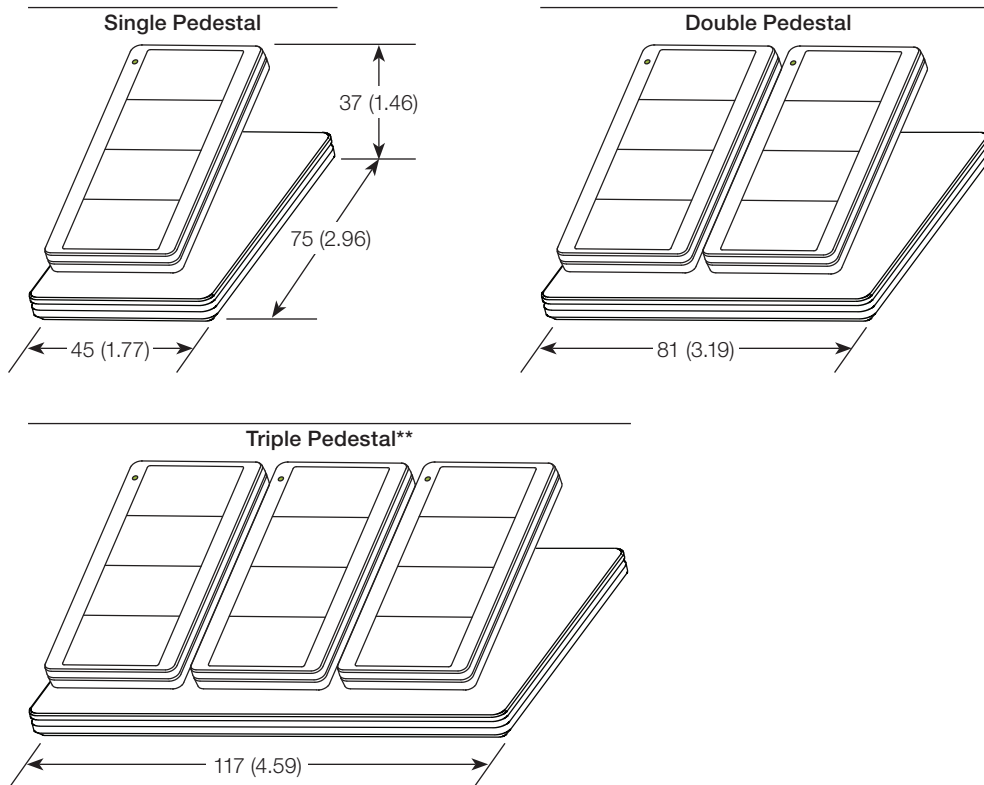

** For Triple Pedestals, contact your local Lutron sales office or visit us at www.lutron.com

Job Name:	Model Numbers:
Job Number:	

Mounting Options

Standalone Mounting:

Adhesive Mounting

Included with Pico wireless control

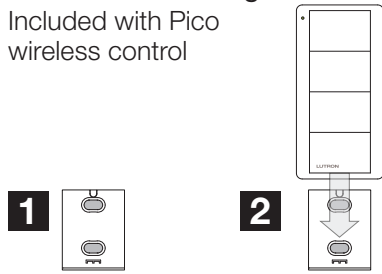

Screw Mounting

Model: PICO-SM-KIT (sold separately)

Kit includes special screws to be used for more permanent mounting and/or for non-smooth surfaces.

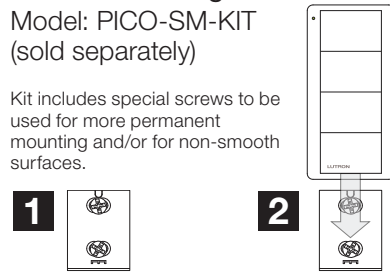

Metal Surface Mounting

Model: PICO-MOUNT-1-XX-CPN6774 (sold separately)

Contact your local Lutron sales office.

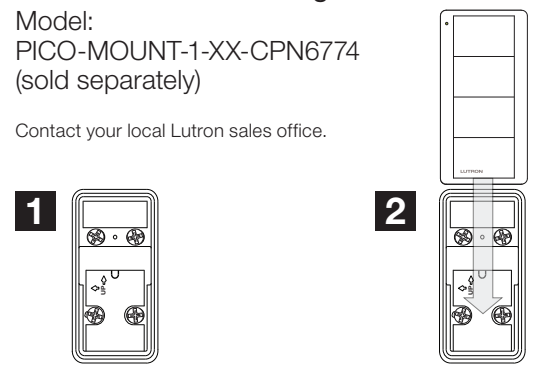

Wallbox Mounting or Surface Mounting:

Square Faceplate Kits (Europe/Asia/India) ^{1,2}

Model: LPFP-S1-XXX (Plastic/Metal); LFGP-S1-CWH (Glass) (sold separately)

Faceplate adapter/faceplate included.

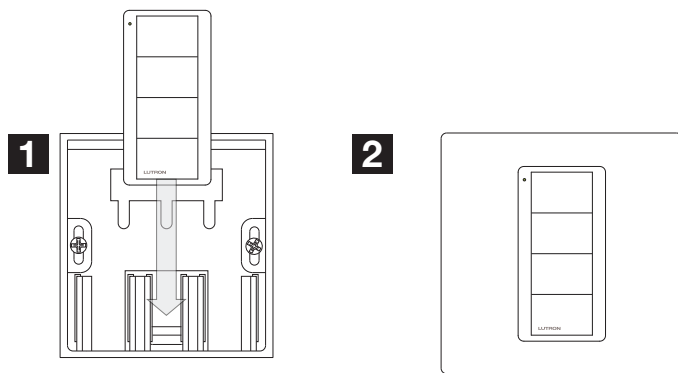

Model: LPFP-S2-XXX (Plastic/Metal); LFGP-S2-CWH (Glass) (sold separately)

Faceplate adapter/faceplate included.

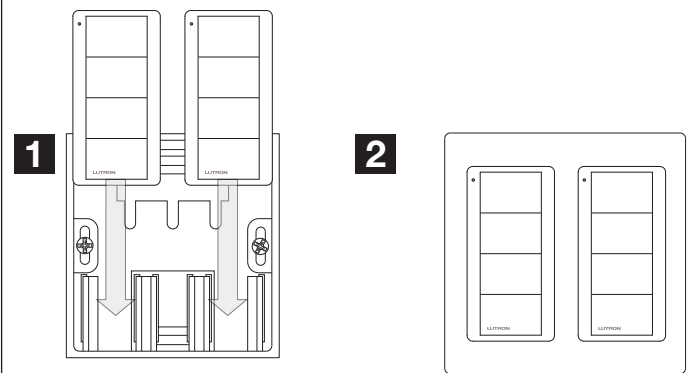

¹ For square or round wallboxes.

² For more information please see Lutron P/N 369884.

<p>Job Name:</p> <p>Job Number:</p>	<p>Model Numbers:</p>
--	-----------------------

Mounting Options (continued)

3-Gang Pico Faceplate Kit

Model: LPFP-S3-TXX-CPN7881

(sold separately)

XX = Color Arctic White (AW)
and Black (BL) available

Dimensions

Measurements shown as: mm (in)

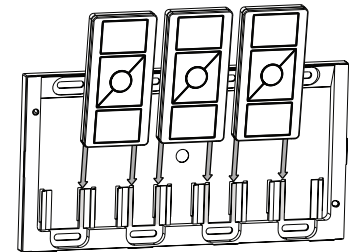
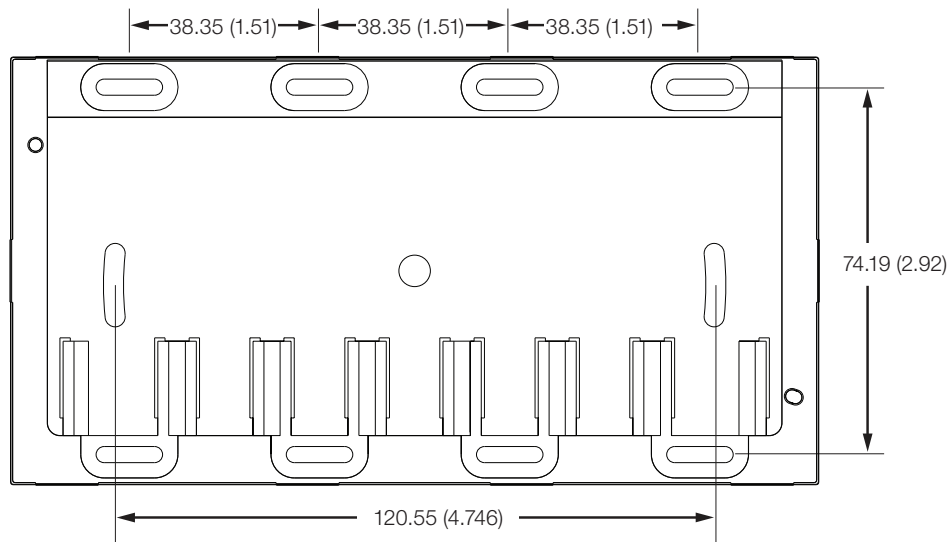

Pico wireless control shown sliding down into mounting grooves in adapter

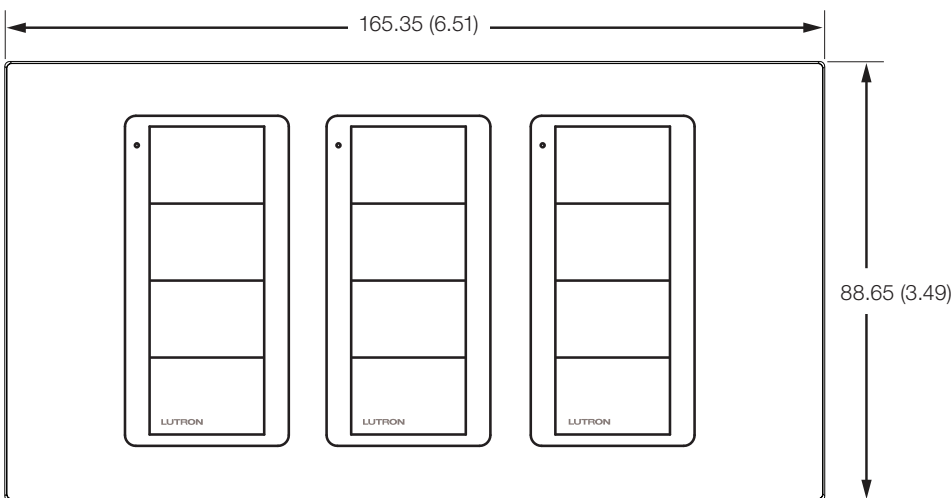

Dimensions shown include faceplate and Pico

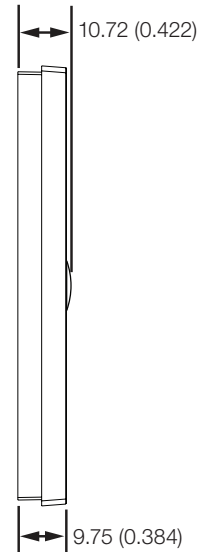

Job Name:	Model Numbers:
Job Number:	

Mounting Options (continued)

Mounting to a Car Visor:

Model PICO-CARVISOR-CL (sold separately)

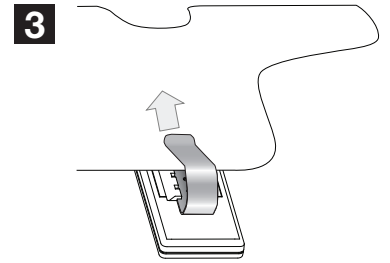
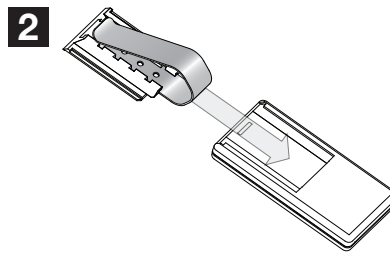
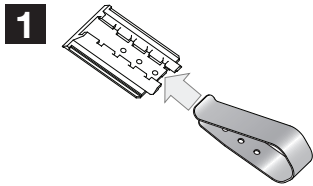

Lutron, Lutron, Pico, PowPak, GRAFIK Eye, HomeWorks, Serena, Sivoia, Quantum, Clear Connect, EcoSystem, myRoom, Energi Savr Node, RA2 Select, and Vive are trademarks or registered trademarks of Lutron Electronics Co., Inc. in the US and/or other countries.

Job Name: Job Number:	Model Numbers:
------------------------------	----------------